

Seal Kit for Stainless Steel Valves Actuator Ø 63/90

Maintenance operations must be carried out by qualified personnel according to manufacturer's instructions. To replace seals, please refer to the instruction manual provided with the valve.

Normally Closed

SPARE PARTS KIT:
Lip seal, o-rings, main seal, body seal

Kit code	DN	Valve Type ¹	Actuator	
856 111 00-	15	PG/RPG/BPG- PN/RPN/BN- PW/RPW/BPW- PB/RPB/BPB- PD/RPD/BPD- PA/BPA/RPA- PC/RPC/BPC- PP/RPP/BPP- PR/RPR/BPR- High Temperature Version	Ø 63	
856 122 00-	20			
856 133 00-	25			
856 144 00-	32			
856 155 00-	40			
856 166 00-	50			
856 611 00-	15		DPG/DPN-	Ø 90
856 622 00-	20			
856 633 00-	25			
856 644 00-	32			
856 655 00-	40			
856 666 00-	50			
856 313 00-	25		PG/RPG/BPG- PN/RPN/BN- PW/RPW/BPW- PB/RPB/BPB- PD/RPD/BPD- PA/BPA/RPA- PC/RPC/BPC- PP/RPP/BPP- PR/RPR/BPR- High Temperature Version	Ø 90
856 314 00-	32			
856 315 00-	40			
856 316 00-	50			

Normally Open

STEM SEALS KIT

Kit Code	DN	Valve Type ¹	Actuator
856 802 00-	all	PG/RPG/BPG/DPG- PN/RPN/BN/DPN- PW/RPW/BPW- PB/RPB/BPB- PD/RPD/BPD- PA/BPA/RPA- PC/RPC/BPC- PP/RPP/BPP- PR/RPR/BPR-	Ø 63/90
856 900 00-	15	High Temperature Version	Ø 63
856 901 00-	20		
856 902 00-	25		
856 903 00-	32	High Temperature Version	Ø 90
856 904 00-	40		
856 905 00-	50		

1. Included versions with optional: stroke regulator (e.g. code PW208STZR0) and travel switch version (e.g. code BPG209LTKJ0)

Seal Kit For Stainless Steel Valves Actuator Ø 45

Maintenance operations must be carried out by qualified personnel according to manufacturer's instructions.
To replace seals, please refer to the instruction manual provided with the valve.

Normally Closed

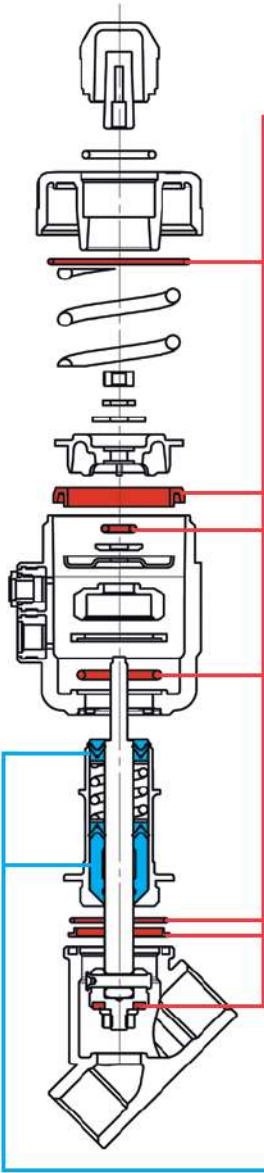

Normally Open

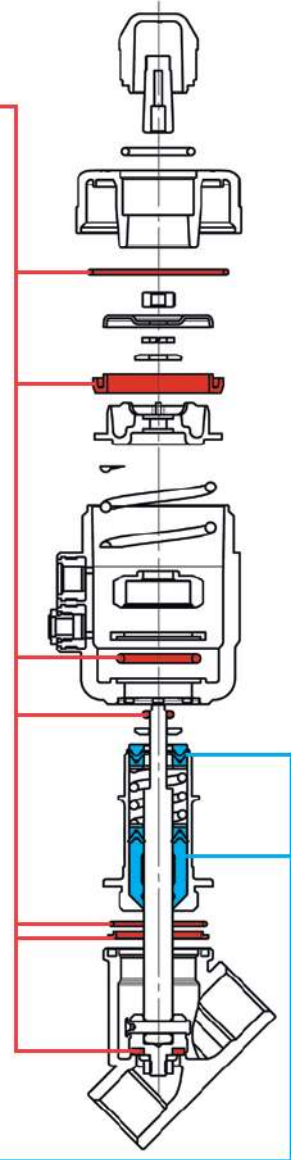

SPARE PARTS KIT: Lip seal, o-rings, main seal, body seal			
Kit Code	DN	Valve Type	Actuator
856 011 00-	15	PG/RPG/BPG- PN/RPN/BPN- PW/RPW/BPW- PB/RPB/BPB- PC/RPC/BPC- PP/RPP/BPP- PR/RPR/BPR	Ø 45
856 012 00-	20		
856 013 00-	15	DPG/DPN-	
856 014 00-	20		

STEM SEALS KIT			
Kit code	DN	Valve Type	Actuator
856 801 00-	all	all	Ø 45